

MEDIUM CULTURAL FESTIVALS (Feb 2023 – Apr 2023)

CULTURAL FESTIVALS AT DARLING HARBOUR

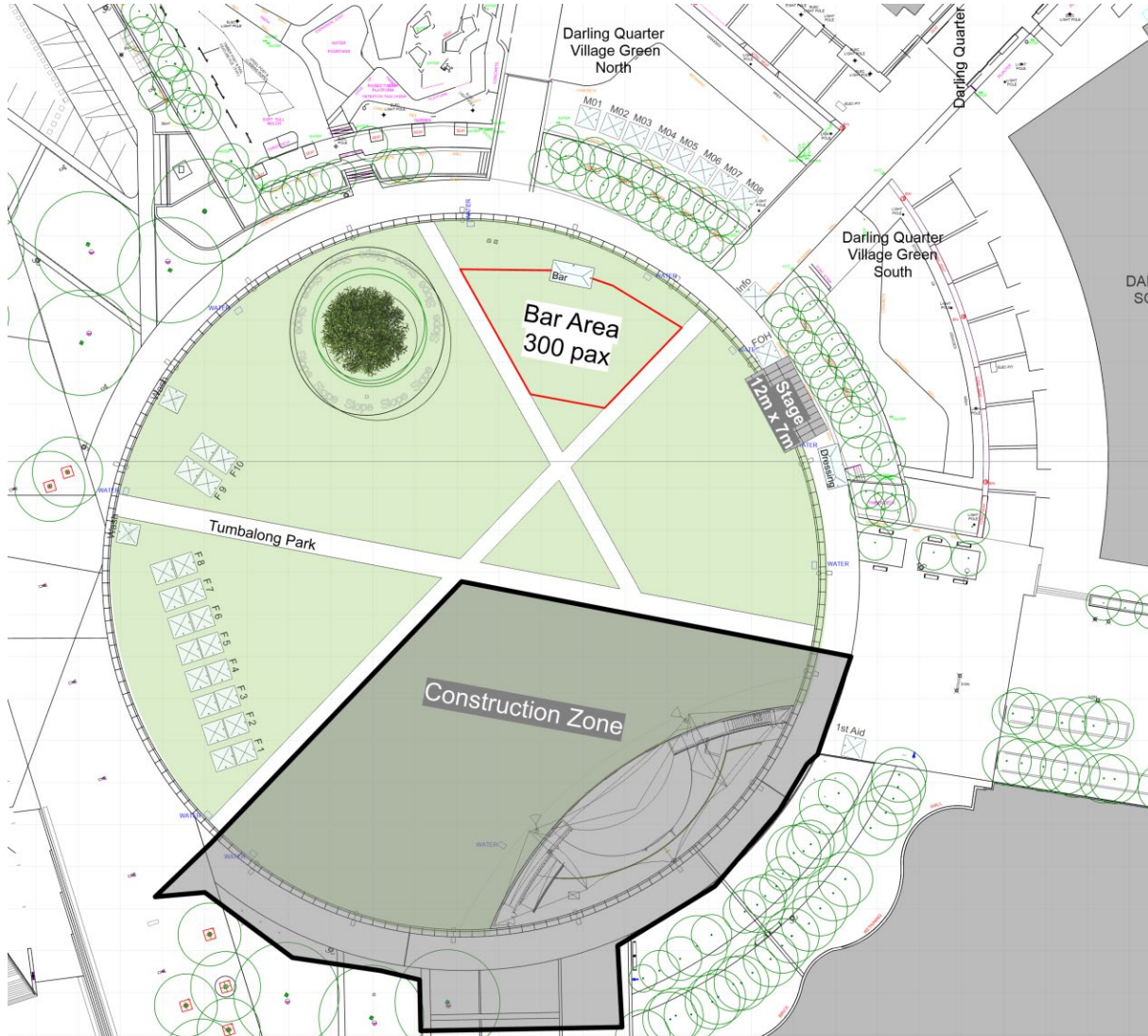

Item	1 Day	2 Day
Application	\$180.00	\$180.00
Deposit/Bond	\$5,000.00	\$5,000.00
ACES Security	\$5,500.00	\$6,000.00
PMNSW Staff	\$12,500.00	\$17,250.00
Cleaning Staff	\$3,100.00	\$4,600.00
Waste Liquid	\$580.00	\$1,160.00
Waste Removal	\$1,300.00	\$2,000.00
Audio/Visual Basic Package	\$1,900.00	\$3,500.00
Audio/Visual Festival Package	-	-
Camera Package	NA	NA
Stage Lighting Package	\$1,795.00	\$3,360.00
Marquee & structures	\$18,400.00	\$18,400.00
Track Mat – (Vehicle on grass)	\$240.00	\$240.00
Fencing – Safe work zone (CCB)	\$1,300.00	\$1,300.00
Cool rooms/Fridges	\$2,800.00	\$2,800.00
Hot hand wash	\$540.00	\$540.00
Signage Stalls	\$2,670.00	\$2,670.00
Fire extinguishers/blankets	\$550.00	\$550.00
First Aid	\$475.00	\$950.00
Plumbing/Gas compliance	\$600.00	\$600.00
Electrical – Power plan	\$600.00	\$600.00
Electrical – Power installation	\$8,510.00	\$8,510.00
Estimated Total (Ex. GST)	\$68,540.00	\$80,210.00

LARGE CULTURAL FESTIVALS (Feb 2023 – Apr 2023)

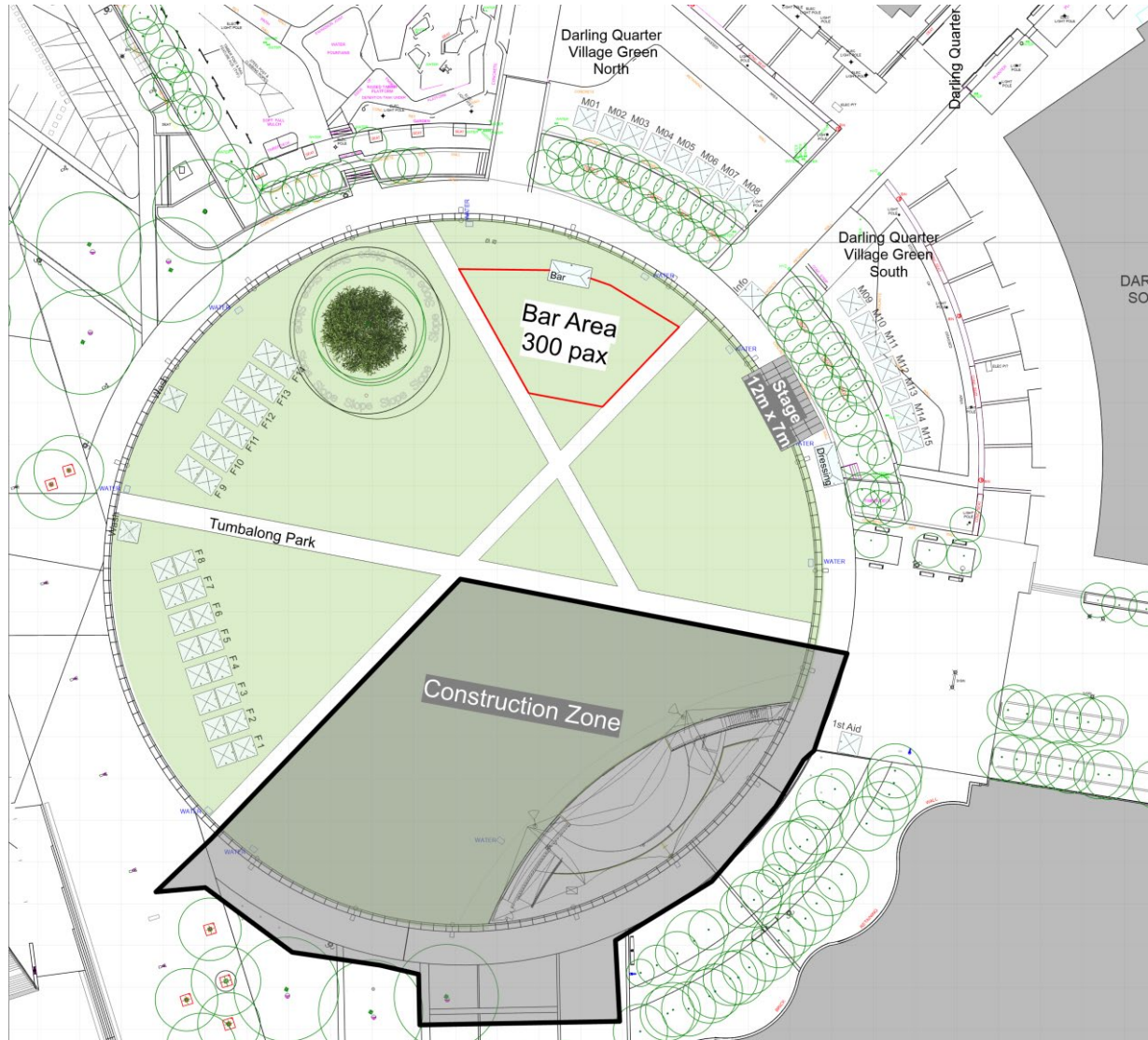

Item	1 Day	2 Day
Application	\$180.00	\$180.00
Deposit/Bond	\$5,000.00	\$5,000.00
ACES Security	\$8,620.00	\$9,200.00
PMNSW Staff	\$12,500.00	\$17,250.00
Cleaning Staff	\$3,500.00	\$5,200.00
Waste Liquid	\$1,000.00	\$1,960.00
Waste Removal	\$1,500.00	\$2,200.00
Audio/Visual Basic Package	-	-
Audio/Visual Festival Package	\$2,350.00	\$4,330.00
Camera Package	NA	NA
Stage Lighting Package	\$1,795.00	\$3,360.00
Marquee & structures	\$27,250.00	\$27,250.00
Track Mat – (Vehicle on grass)	\$240.00	\$240.00
Fencing – Safe work zone (CCB)	\$1,300.00	\$1,300.00
Cool rooms/Fridges	\$3,860.00	\$3,860.00
Hot hand wash	\$1,840.00	\$1,840.00
Signage Stalls	\$3,795.00	\$3,795.00
Fire extinguishers/blankets	\$750.00	\$750.00
First Aid	\$475.00	\$950.00
Plumbing/Gas compliance	\$600.00	\$600.00
Electrical – Power plan	\$600.00	\$600.00
Electrical – Power installation	\$12,000.00	\$12,000.00
Estimated Total (Ex. GST)	\$89,155.00	\$101,865.00